

Towel Rail Installation Instruction Sheet

SC-361

* Please be sure to read before installing product.

* Do not dispose the installation sheet after installation, instead please pass it to the product user.

KAWAJUN

www.kawajun.co.jp

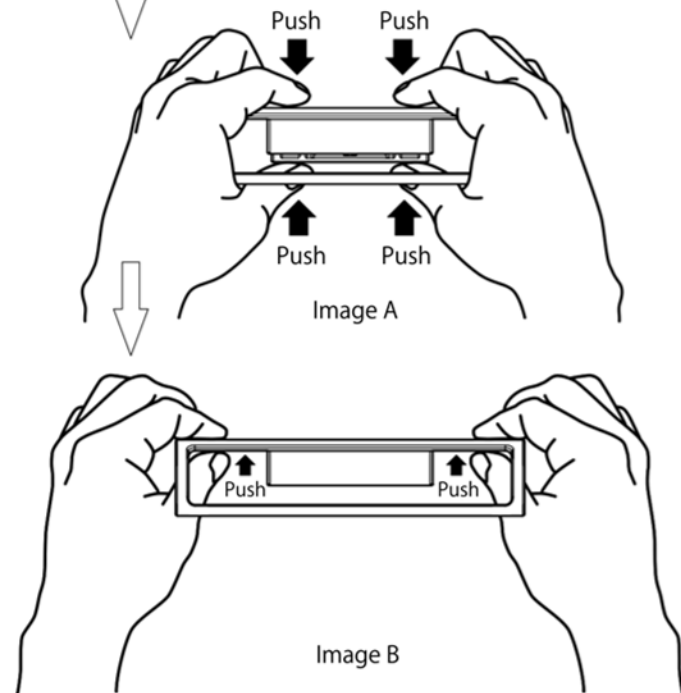
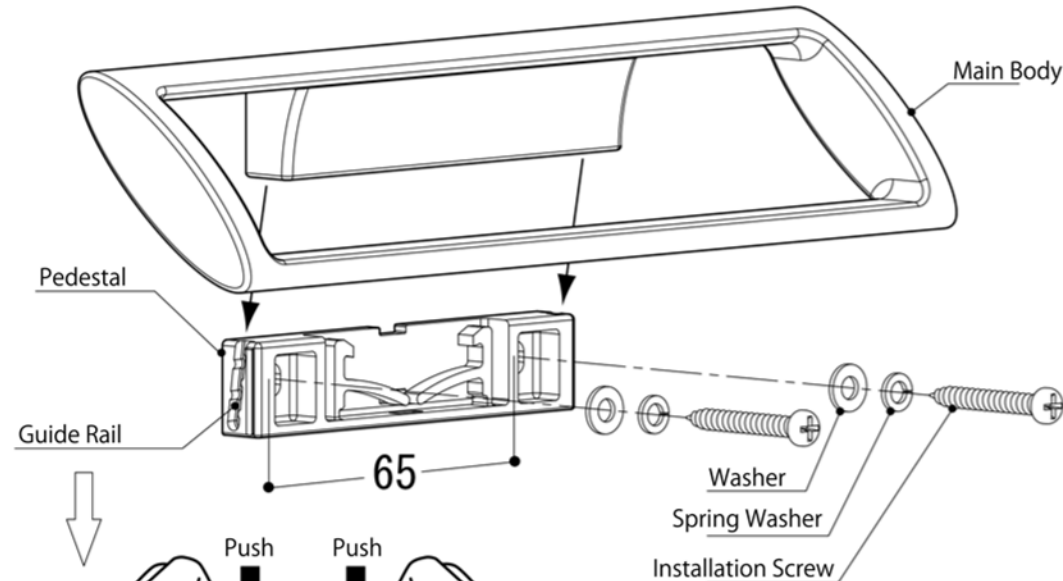

◎ Removal of Cover

Insert minus screwdriver head into groove and push Main Body out.

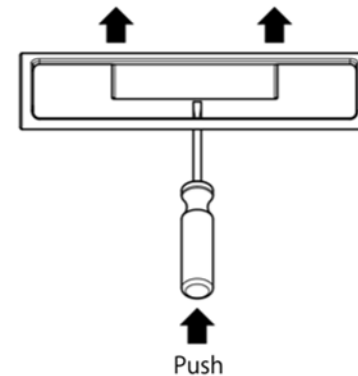

◎ Installation Procedure

1. Install Pedestal to wall using the provided Washers, Spring Washers, and Installation Screws.
2. Slide Main Body onto Pedestal from the top.
3. Clasp Main Body to Pedestal by pinching them together, as shown in Image A, until you hear a click.
* If no click is heard, hold the sides of Main Body and push it up to test if it is secured or not, as shown in Image B.

⚠ Caution: About installation

- * If product is to be installed on boards, please ensure it is at least 9mm thick.
- ** Do not install on non-reinforced walls.
- * Do not install product on ALC or in spaces between concrete blocks.
- * After installation, please check to ensure product has been installed properly. If product has not been installed properly, it may wobble and drop off.

* Avoid direct contact with water. Do not install product in areas with very high temperature.

⚠ Caution: About product usage

- * The load capacity is 10kgf. Do not load heavier than the stated load capacity. Product failure may result in injury.
- * Do not use product for unintended purpose or application. Product failure may result in injury.
- * Do not use gasoline (Benzene), thinner, alcohol, acidic/alkaline based detergent and/or cleanser to clean the product.

NO. 001