

Please read this instruction sheet before installation.

AC774/784 Door Catcher Installation Instructions

(Please retain this instruction sheet along with the wax cover after installation.)

Installation Condition: Space between the floor and the door edge must be within 10~20mm.

Feature (AC774)

① Pushing on the door causes the strike to hit the bumper, which will cause the ring to rotate and catch the door in place.

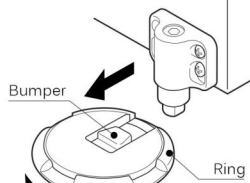

② Catch State

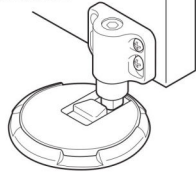

③ Pushing on the door once more, pushes the bumper to rotate the ring, releasing the door from the catch state.

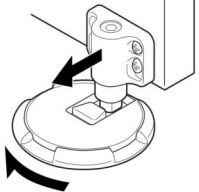

④ Release State

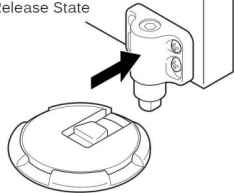

※In the event of resistance met when pushing against the door, you can use your feet to gently push on the door to help it along.

Important

When using the door catcher, please always maintain contact with the door, lever handle, etc for support.

① Position confirmation before installation



Check for allowances
Before installation, please ensure that the position of the strike is within 10~100mm from the edge of the door.

As for the base, please ensure that when the door is wide open, the lever handle does not hit the wall before fixing the base into place.

Installation Warning

Please refrain from installing the door catcher close to the hinged side of the door or too close to the wall where there is a risk of the lever handle hitting the wall.

Check and allow sufficient space between the door and the wall before fixing the door catcher into place.

② Strike Installation

Once the position of the strike is confirmed, please match the bottom of the strike to the bottom edge of the door and adjust the length of the strike pin to a suitable length with the allen key provided.

(For AC784, please detach the strike from the strike base with a minus driver and adjust the length of the strike pin with the allen key provided.)

About Strike Installation

The length of the strike pin can be adjusted by inserting the allen key provided into the top of the strike and turning it in the clockwise direction. Please adjust the pin so that the distance between the floor to the pin is within 3.5 ~ 5mm.

(For AC784, after adjustments is complete, please attached the strike back to it's base.)

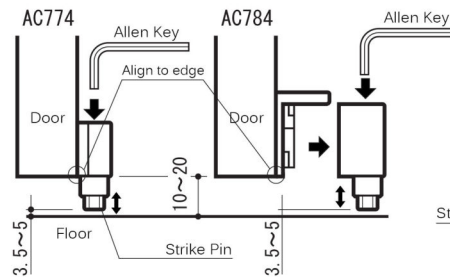

③ Base Installation

To confirm the installation position of base, test by first positioning the base on the floor and while swinging the door open with the strike installed, check that the strike pin is able to hit the bumper properly and that there is sufficient space allowance to prevent the lever handle from hitting the wall.

Next, fix the cover in place according to the direction shown in Image 1.

- ※For flooring more than 11mm thick, proceed with the installation according to the instruction sheet.
- ※For flooring less than 11mm thick, please use the longer screws and screw plug provided for installation.
- ※For carpet flooring, please install door catcher with the carpet base.

Important Please attach the main body to the door perpendicularly.

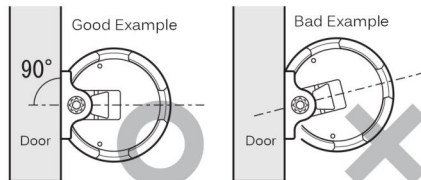

Important Please avoid installing directly over flooring joints. If installing over flooring joints is unavoidable, please loosen the installation screws by half a turn. (Avoid over-loosening of the installation screws though.)

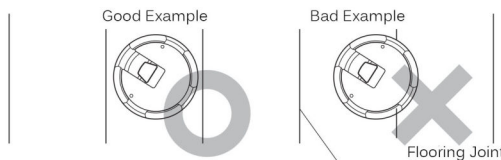

Important

If possible please avoid using an electric screwdriver to tighten the screws fully. Instead, please use a screwdriver to lightly tighten the screws all the way to the end.

AC774 Installation

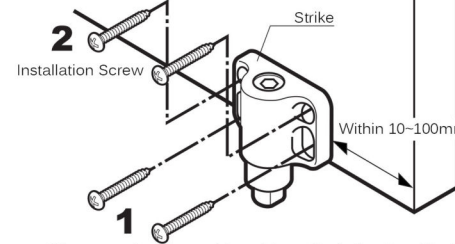

(Please confirm the position of the strike before installing.)

AC784 Installation

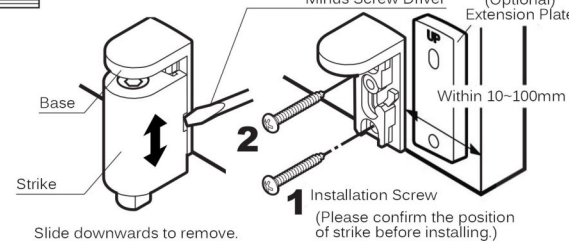

Slide downwards to remove.

Direction of Strike Pin

The strike pin's default direction is with the narrow side of the pin facing outwards. If the strike pin's position is changed to the broader side, the space between the door and the base will increase. (Broad side is for height adjustment use.)

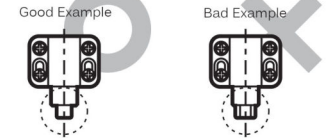

Important

Please ensure that strike pin placement is perpendicular.

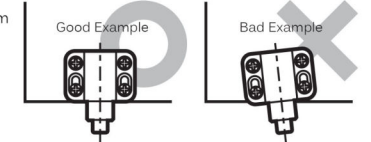

④ After Installing & Maintenance

Please check door stopper operation when installation is complete.

Important

After installation, please check to ensure that the ring rotates easily. If it does not, loosen the installation screws by half a turn. (Avoid over-loosening of the screws.)

Important

Once installation check is complete, please cover stopper with the wax cover provided until after construction work ends.

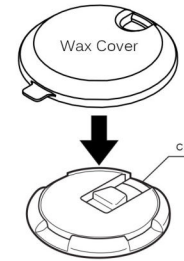

※If product does not operate properly, please refer to the troubleshooting instructions on the back page.

Installation of Cover

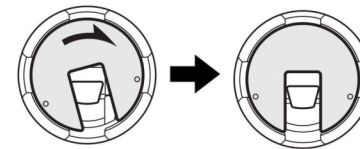

Place the cover in the position shown in the example above and rotate it in the clockwise direction to fix it in position. To remove, rotate in the anti-clockwise direction.

Image 1

It is easy to attach/detach the cover by simply rotating it with the palm of your hand.

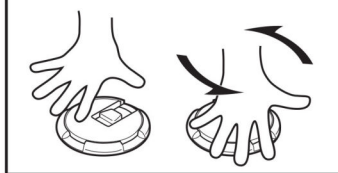

⚠ Regarding Installation

- During door catcher installation, please ensure that the door catcher is positioned and installed in a position whereby when the door is held open, the lever handle is unable to touch the wall.
- Please note that the product comes default with wood screws for wood flooring installation. For carpet flooring, a separate carpet adapter needed to be purchased.
- Avoid installation over flooring joints.
- When installing on flooring that is less than 11mm thick, please install using the long screws and screw plugs provided.
- Direct installation must not be done on concrete or tiled floors.
- Avoid installation of door catcher in outdoor spaces or wet areas (eg. bathrooms).
- When using an electric screwdriver, please do not tighten the screws all the way. Instead, please use a screwdriver to lightly tighten the screws all the way to the end.

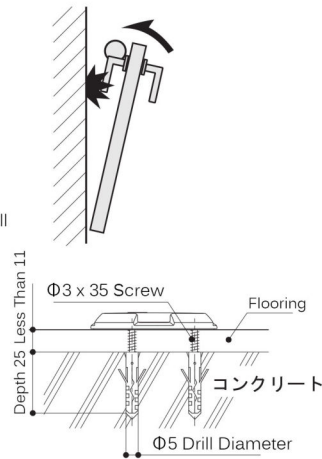

⚠ Usage of Door Catcher

- The stationary weight capacity of this product is 40kgf and the directional weight capacity is 50kgf. (Sudden impact weight capacity 60kg.m/s) Strike pin breakage, door (glass door, etc) breaking and causing injuries might occur if weight limit is broken. (60kg.m/s = A direct bodily collision with a child younger than 25 years old with an approximate weight of 25kg.)
- Product is designed with a safety trigger that will automatically release the door or window when weight capacity has exceeded. In the events of strong wind (from window or entranceway) the safety trigger might get activated, so for situations like this, please try to keep the door shut and avoid using the door catcher.
- Please avoid standing on top of the product or placing heavy objects like drawers and desks, etc on the product. Product is liable to get damaged.
- Please do not allow contact of wax on the product. In the events of floor waxing, please use the wax cover provided to keep the base protected from the wax.

Only remove the wax cover after the wax has dried completely.

☉ Maintenance

- Regularly use a soft and dry cloth to keep the product clean. (Avoid using too much strength than necessary to avoid scarring the product surface.) In the events of stubborn stains, please use a soft cloth soaked in water containing a small amount of diluted synthetic detergent to remove the stain. Finish by using a soft and dry cloth to remove all moisture.
- If the operation of the door catcher were to become stiff over time because of dust or sand entering the catcher base. While referring to the images below, remove the cover of the door catcher by pressing and turning the cover 15 degrees anti-clockwise with the palm of the hand and clean out the dust or sand. After cleaning out the dust or sand, please oil the catcher with a silicon spray.

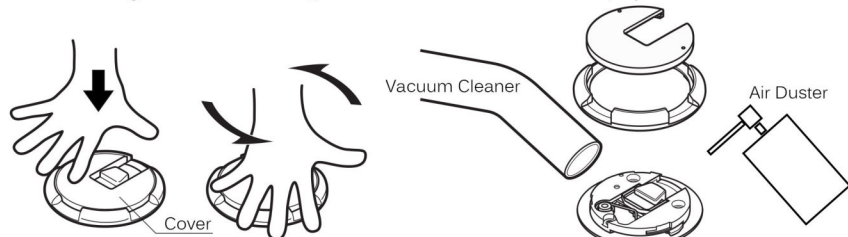

Rotation of the cover will be easier with a rubber glove. (Please do not rotate more than 15 degree.)

After removal of the cover and ring, please clean out the dust, etc with either a vacuum cleaner or an air duster. (Beware of spring dislocation.)

Product Troubleshooting Chart

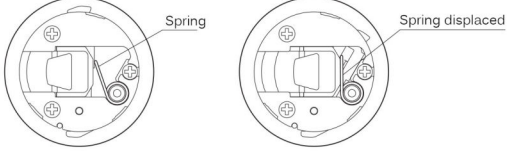
Ring does not rotate or has trouble rotating.		(Ring should turn easily. If not, please adjust accordingly if ring rotation is stiff.)
① Wax hardening has affected all movable parts.	● Remove cover and ring for reassembly and remove all foreign obstructions (e.g. wax bits). Check product operation after reassembly. Product should operate normally again after reassembly, if not, a replacement is in order. ※Problem can be prevented by protecting door stopper with the wax cover provided in the events of floor waxing.	
② Internal spring position displaced. ※Occurs only when product was operated without the cover in place. Reassemble by replacing the spring back to its original position and the cover in place.	● Remove the cover and replace the spring back to its original position. ○ Normal State ○ Spring Displaced State 	
③ Product installed directly over flooring joint. ※Catcher base unstable because of difference in floor height.	● Please avoid installing on uneven flooring joint, but if unavoidable, loosen the installation screws by half a turn. (Avoid over-loosening of screws.) ● If problem cannot be resolved with the loosening of the screws. Either purchase the optional carpet base or attempt to level out the base by adding a few layers of adhesive tape under the catcher base.	
④ Foreign objects (dust; rubbish) entering base during installation.	● Remove cover and remove the foreign objects with either a vacuum cleaner or an air duster. ※Cover product with wax cover provided during construction period.	
⑤ Strike unable to hit the bumper of the door catcher.	● Reposition and reinstall door catcher base. (Possible causes below.) 1. Position of catcher base to ensure that strike hits the bumper is off. 2. Installation angle of the base to the door is off. 3. Length of the strike pin is not long enough to hit the bumper. Please use allen key provided to adjust strike pin's height.	
⑥ Installed on carpet floor.	● Direct installation on carpet floors not recommended. Please purchase the additional carpet base for carpet floor installation.	
Ring does not rotate completely.		(Problem occurs when catcher base is not covered with the wax cover provided after installation is completed during construction period or when the ring has been left in a half rotated position for a long period of time.)
① Problem with the spring creating tension to the ring.	● Slowly rotate the ring and stop when a "snick" sound is heard. Allow the door catcher a recovery time of 2 hours or more and during this period, please refrain from using the door catcher.	
② Presence of foreign objects (dust; rubbish) in the bumper causing delayed reaction.	● Remove cover and remove the foreign objects with either a vacuum cleaner or an air duster. ※Cover product with wax cover provided during construction period.	
Strike does not catch and is unstable.		(Occurs when pushing force is insufficient.)
① Bent door, resulting in lever handle hitting the wall.	● Base position was installed incorrectly. Reinstall base further away from the wall and closer to the outer edge of the door. (Refer to Strike Installation for clearer explanations.)	
② Lever handle hitting the wall.	● Base position was installed incorrectly. Reposition and reinstall base further away from the wall.	
③ The strike pin's length is not long enough.	● Please use the allen key provided to adjust the height.	
Abnormal sounds during product operation.		(Caused either by the following reasons below or possible deformation of product parts.)
① Dust or rubbish entering the base during installation.	● Open the cover and clean out all obstructing particles and use any commercial silicon spray to oil the door catcher.	
② Warped floor surface.	● Resolved either by changing the installation location or loosening the installation screws by half a turn. If still unresolved, attempt to level out the base by adding a few layers of adhesive tape under the catcher base.	

● Please contact our retailer if you encounter any other problems not listed above.