

## Sanitary Accessory Installation Instruction Sheet

### SH-016-3 (Towel Bar Handle)

#### Safety Warning

- \* Please be sure to read "Safety Warning" before installation to ensure product will be installed properly.
- \* Customers who have purchased this product from the online shop should read the attached "Disclaimers and Warranties" and "Precautions" before installation.
- \* Do not dispose the installation sheet after installation, instead please pass it to the product user.
- \* Pass all tools that have been provided to product user.
- The following displays shows the levels of harm or damage if product is not installed properly.

**Warning** This display warns the possibility of death or serious injury.

**Caution** This display warns the possibility of injury or possibility of physical damage.

■ The following symbols shows the precautions that needs to be observed.

**No** This symbol is used to identify prohibited actions that must not be carried out.

**Exclamation Mark** This symbol is used to identify mandatory actions that must be carried out.

#### Warning About installation

- Exclamation Mark** \* Do not install this product on glass doors that are thicker than what is stated.
- Exclamation Mark** After installation, please check to ensure product has been installed properly. If product has not been installed properly, it may wobble and drop off, resulting in injuries.

#### Warning About product usage

- No** Do not use product for unintended purpose or application. Product failure may result in injury.
- No** Do not load heavier than the stated load capacity. Product failure may result in injury.
- No** Do not apply excessive force onto product. Product failure may occur and lead to injury.

#### Caution About product maintenance

- No** Wipe away any stain of cosmetic or chemical product when found. Leaving stains on product may lead to discolouration, corrosion and/or deterioration and result in breakage and injury.
- No** Wipe with a soft, damp cloth. When necessary, wipe a damp cloth with mild detergent and finish with a soft, dry cloth. Do not use gasoline (Benzene), thinner, alcohol, or acidic/alkaline based detergent and/or cleanser to clean the product.

#### Product Specification

Type	Towel Bar Handle
Product Code	SH-016-3
Material	Aluminium
Product Dimension	500 x 64.5 x 25mm
Load Capacity	588N (60kgf)
Glass Thickness	8~12mm
Hole Dimension	Ø16 (2 places)

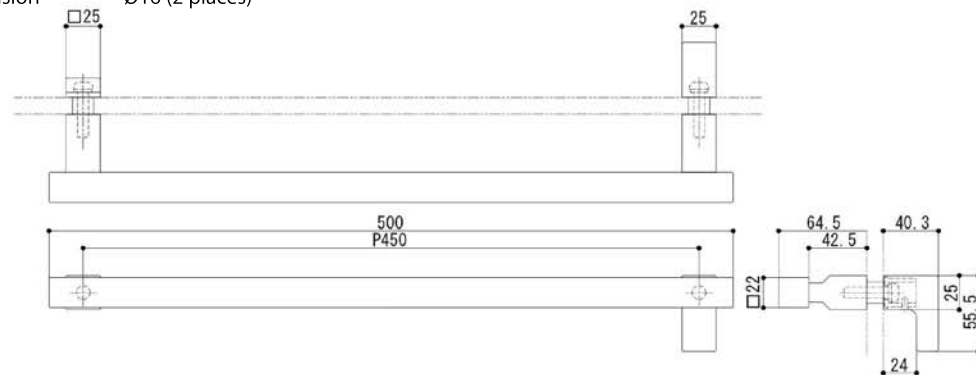

#### Package Contents

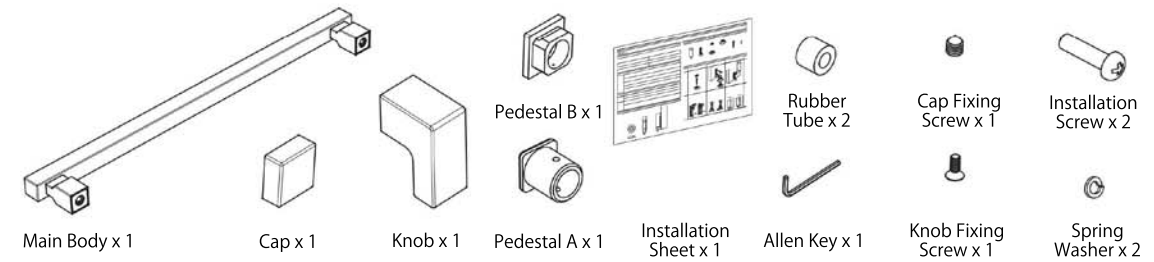

#### Installation Procedure

- Ⓞ Installation Procedure
1. Insert Rubber Tubes into glass holes.
  2. Install Main Body using the provided Pedestals, Spring Washers, and Installation Screws.
  3. Fix Knob onto Pedestal A and install using Knob Fixing Screw.
  4. Fix Cap onto Pedestal B and install using Cap Fixing Screw and Allen Key.
  5. Check product after installation to ensure it has been installed properly.

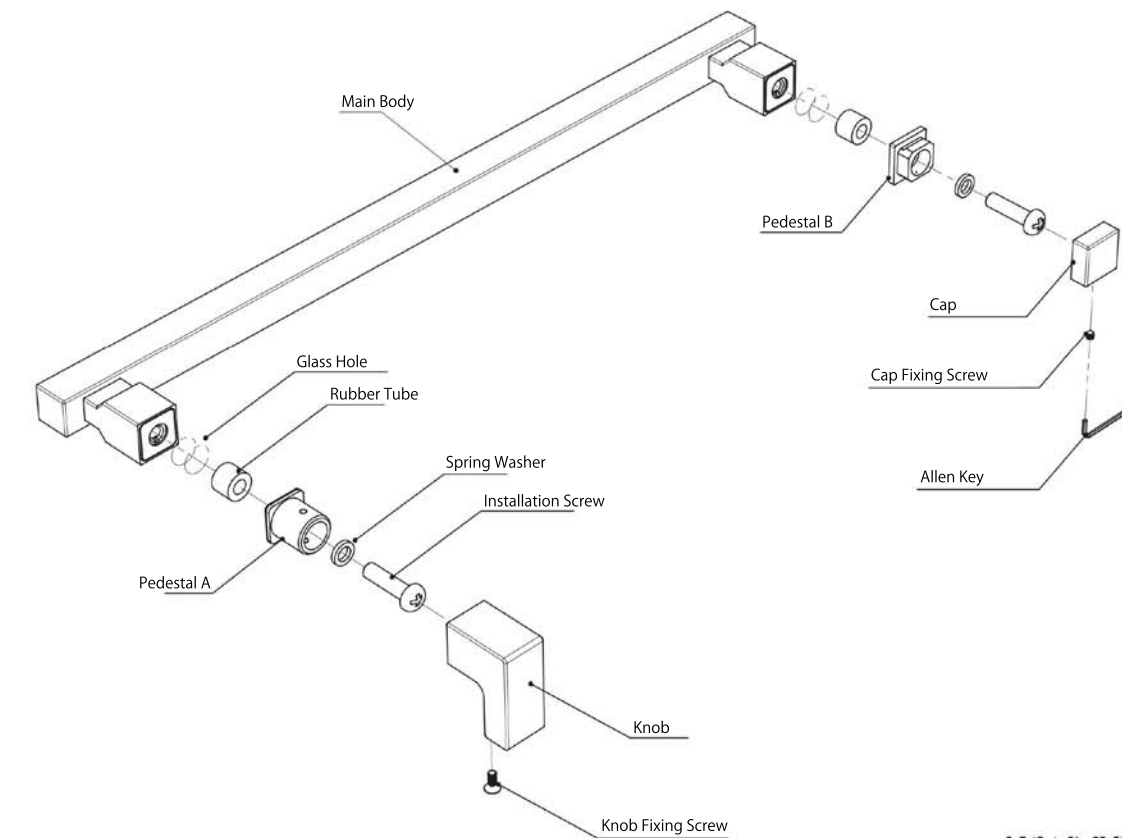

**KAWAJUN**  
www.kawajun.co.jp

NO.001